

1. Getting Started

Kit Contents

- 3.5" TURBO LEOPARD Enclosure
- USB3.0 Cable
- Power Adapter
- Installation CD
- Screw Pack
- Stand
- QIG

Minimum System Requirements

- Available USB3.0 Host port
- Windows XP / VISTA / 7

Product Overview

1. Power / Access LED
2. OTB Button
3. USB3.0 Port
4. DC Jack
5. Power Switch

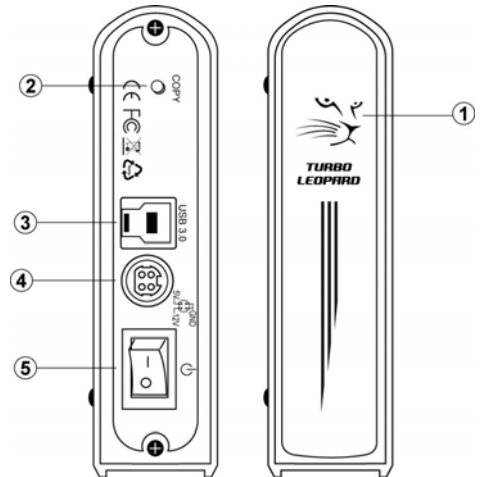

2. Assembling the 3.5" SATA HDD

Step 1 : Open the enclosure , and put out the PCB tray.

Step 2 : Insert SATA HDD into the SATA connector of PCB.

Step 3 : Put in the screws and tighten SATA HDD.

Step 4 : Connect the Power LED cable on PCB, position the PCB and HDD set carefully into the aluminum casing, put the screws in and tighten them.

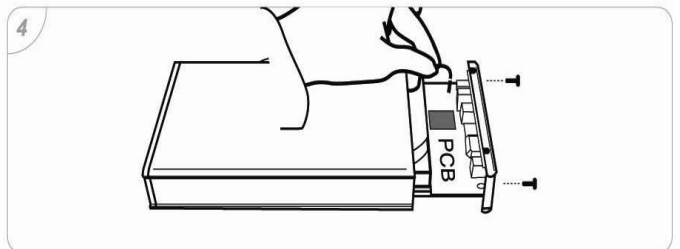
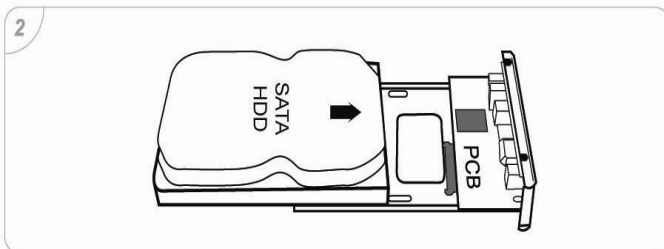
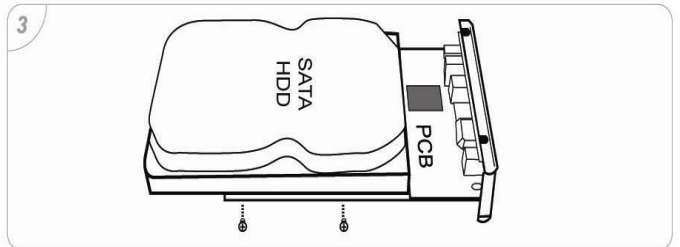
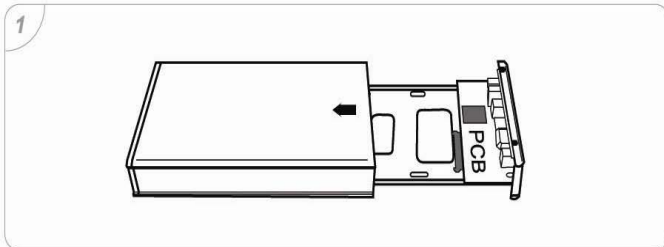

3. Connecting the Drive

1. Connect one end (USB3.0 A Type) of the USB3.0 Cable to your computer.
2. Connect the other end (USB3.0 B Type) of the USB3.0 Cable to the USB3.0 port on the back of the enclosure.
3. Connect the power adapter to the power socket of the enclosure and switch the power on.
4. The power indication LED (on the front panel) will illuminate and the presence of an external drive will be visible on your PC monitor or laptop.

4. Installing OTB Software

Note : OTB supports Windows32bit system only.

1. Put Installation CD-ROM into the Optical Drive on your computer or laptop.
2. Select the correct OTB software version and then follow the installation procedures.
3. Once OTB is successfully installed on the computer or laptop, an OTB icon will appear on the system tray of your computer.

5. Disconnecting the Drive

Caution : To prevent data loss, always be sure to close all active applications before shutting down the drive.

Windows

1. Double-click the Safely Remove Hardware icon in your system tray (typically located on the bottom right corner of your desktop).
2. Select the appropriate device from the list and click "Stop". Click "OK" to confirm your selection of the drive to be disconnected.
3. Click "Close" and ensure that the drive is powered off already.

6. Remarks

1. The detailed installation manual can be found in the "User Manual" of the CD.
2. The product is compliant with CE/FCC/UL/RoHS/WEEE.